



SALE, PENTHOUSE, 102 SQ.M., 3 BEDROOMS



<b>Price:</b>	275 000 €	<b>Location:</b>	SPAIN, Murcia, San Pedro del Pinatar
<b>Lot:</b>	m-2063C	<b>Total area:</b>	102 m <sup>2</sup>
<b>Type of transaction:</b>	Sale	<b>Bathrooms:</b>	2
<b>Property type:</b>	Penthouse		

### Features:

- ✓ Taras
- ✓ Klimatyzacja
- ✓ Close to Shops
- ✓ Solarium
- ✓ Garaż
- ✓ Winda
- ✓ Close to Beach

### Description:

Lo Pagan.  
Primary market.  
Parterrace: 18 m2.  
Solarium: 98 m2.  
Lift: yes.  
Basement: no.  
Air-conditioning: yes.  
Facilities.  
Garage: underground.  
Veranda: no.  
Close to beach.  
Close to shops.  
Energy certificate.

The Sol & Playa property is located 300 metres from the sea and the port of Lo Pagan. This lively seaside resort has everything to offer, from restaurants, bars, shops etc.... Choose from two or three bedroom flats with two bathrooms, as well as penthouses with a rooftop solarium. Each flat has a spacious living room with open-plan kitchen, two or three spacious bedrooms with built-in wardrobes and two bathrooms, including a master bedroom with en-suite bathroom and a spectacular 10 m2 terrace. The penthouses have private rooftop solariums where you can relax and enjoy the beautiful views. Also equipped with a private garage, your car will always be safe. The Sol y Playa building in San Pedro del Pinatar, Murcia, offers much more than a flat; it is the gateway to a life of comfort, luxury and tranquillity. This new home with modern design, bright spaces and high-



---

quality details. A place where dreams come true. The location of the Sol y Playa building is more than privileged, it is the epicentre of everything that makes living in Costa Cálida a unique experience. Just 300 metres from your new home, the beach of San Pedro del Pinatar with its crystal clear waters and golden sand awaits you. Here you can relax in the sun, take long walks along the seafront or enjoy exciting water sports. The sunsets are simply spectacular and will be the perfect backdrop for romantic evenings. In addition, just a few steps away from the Sol y Playa building is a lively entertainment area. First-class restaurants, charming bars and quaint shops provide a wide range of options to enjoy special moments with friends and family. If you're a golf enthusiast, you'll be delighted to know that renowned golf courses are just 10 kilometres from the flat, where you can perfect your game in spectacular surroundings. And for those who love spontaneous travel, the airport is just 30 kilometres from the flat, meaning you'll be just a short drive away from discovering new places and experiencing unforgettable adventures.



Photos:

---

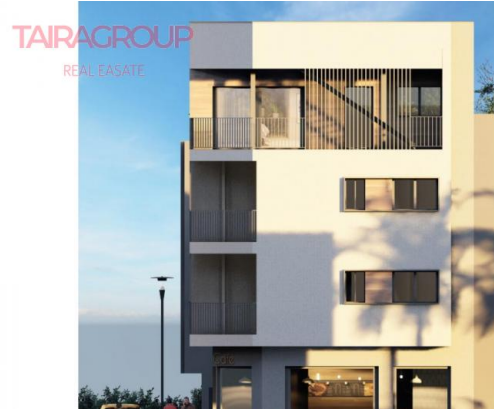



## REAL EASATE

